



**FOT 995** Single lever kitchen tap with aerator integrated in the spout



Fingerprint-  
Proof



Saving Water



Anti-scale  
aerator



Swivel spout



Easy  
installation



PVD

**DESCRIPTION**

Single lever kitchen tap with aerator integrated in the spout

**COLOURS**



**REFERENCE**

REF. 116030035  
EAN. 8434778009262



**FOT 995**

## **FEATURES**

Metallic Edition, Titanium Collection  
High spout kitchen tap  
Swivel spout  
Anti-scale aerator  
Cartridge with ceramic discs of high resistance  
Highly precise temperature control  
Greater handling sensitivity with smoother movements  
Easy-Quick fixation system  
3/8" - 1/2" flexible inlet pipes



**FOT 995**

## DIMENSIONS

**Product height (mm):** 420

**Product width (mm):**

**Product depth (mm):**

**Product length (mm):**

**Net weight (Kg):** 0,95

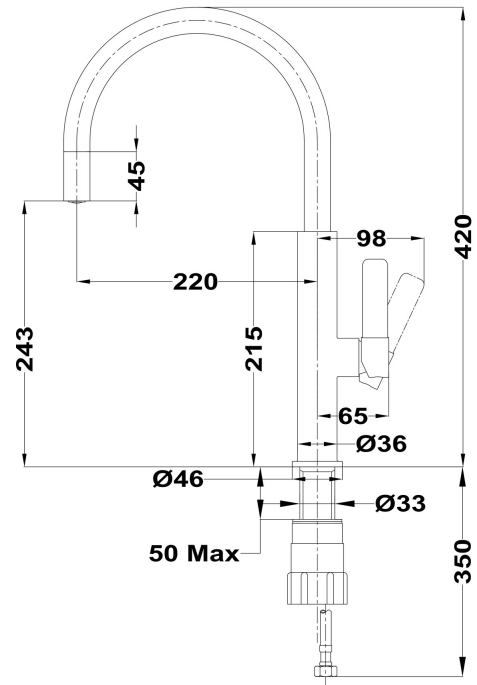

## TECHNICAL DETAILS

### MODELS

**Type of installation:** Free standing

